

# INSTALLATION MANUAL

10108FD

ecodownlight

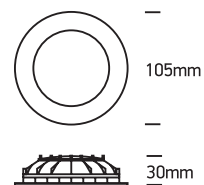

230V | SMD 2835 | 8W | IP20 | Die cast  
Complete with 300mA driver.

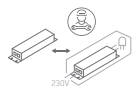

80 CRI

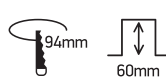

one  
LIGHT

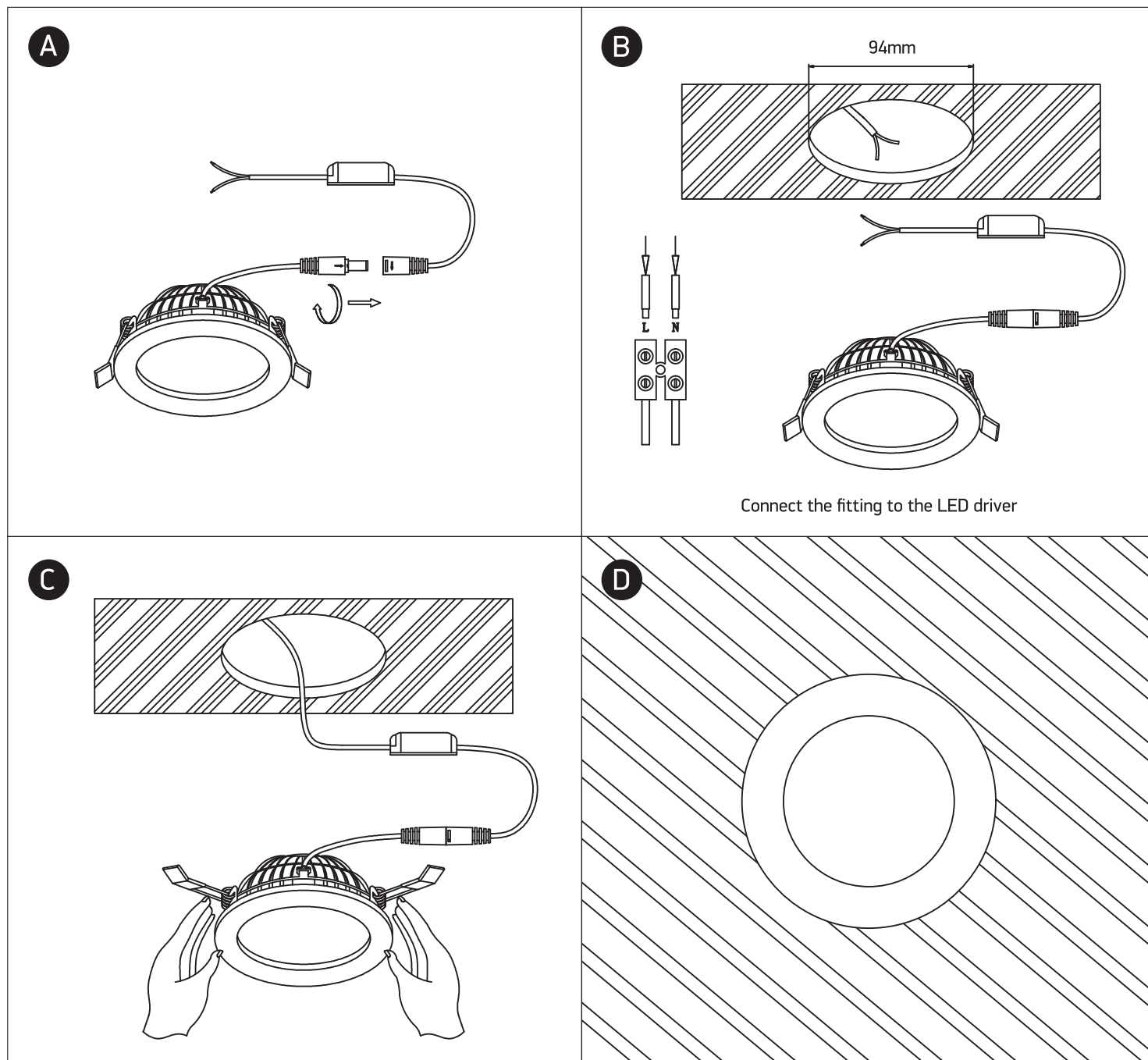

## Warnings:

1. Make sure that the product is installed properly before connecting to electricity.
2. Do not cover the fitting.
3. Maintenance and installation should only be carried out by a professional electrician.